

LINKS





LINKS

TABLE OF CONTENTS

	Page
Cold Shuts	1
Lap Links	2
Master Links	3
Pear Shaped Snap Links	4
Pear Shaped Weldless Links	5
Quicklinks	6
'S' Hooks	7
Twin Links (Double Clevis)	8

Cold Shuts

The most inexpensive method of repairing or connecting chain.
Mild Steel - Electro Galvanized



Cold Shuts		Dimension Inches		Weight lbs/pc	WLL (lbs)	Product Code
Size		A	B			
3/16"		0.890	0.830	0.03	450	29170012
1/4"		1.313	0.375	0.06	750	29170016
5/16"		1.430	0.410	0.10	1,250	29170020
3/8"		1.250	0.625	0.18	1,900	29170024
7/16"		1.375	1.250	0.26	2,650	29170028
1/2"		1.600	1.250	0.38	3,500	29170032

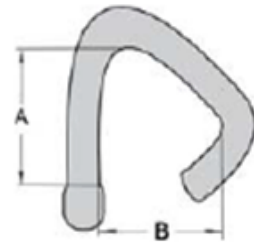

Design Factor: 4 : 1

- * When using cold shuts with chain, use one size larger than the chain size.
- * With a hammer, drive the open end through the cold shut eye and peen the extended end to prevent opening
- * cold shuts should not be reused after closure has been made.

WARNING : NEVER EXCEED WORKING LOAD LIMITS OF CHAIN OR COMPONENTS!
DO NOT USE for overhead lifting or hoisting
DO NOT USE if the chain or component are visibly distorted or worn.

Lap links

For quick permanent repair of chain
Cold drawn Mild Steel - Electro Galvanized or Ungalvanized



Lap Links		WLL (lbs)	Weight lbs/pc	Product Code
D	L			
3/16"	1"	240	0.03	29161210
1/4"	2"	400	0.04	29161620
5/16"	2"	950	0.17	29162020
3/8"	2"	1,250	0.26	29162420
1/2"	2-1/2"	1,525	0.53	29163225
5/8"	* 2-1/2"	1,000	0.81	29164025

* Side opening

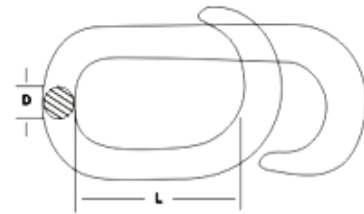

Design Factor: 4 : 1

- * For use in connecting low carbon chain of equal or lower working limits.
- * Thread onto the link and the link is flattened
- * Link must be closed before using

WARNING : NEVER EXCEED WORKING LOAD LIMITS OF CHAIN OR COMPONENTS!
DO NOT USE for overhead lifting or hoisting
DO NOT USE if the chain or component are visibly distorted or worn.



Weldless Alloy Master Links

Alloy Steel
Quenched and Tempered



Master Links				WLL (lbs)	Weight lbs/pc	Product Code
Inside						
Size	W	L	D			
1/2	2-1/2"	5"	1/2"	4,100	0.89	39320032
5/8	3"	6"	5/8"	5,500	1.63	39320040
3/4	2-3/4"	5-1/2"	3/4"	8,600	2.25	39320048
1	3-1/2"	7"	1"	20,300	5.00	39320100
1-1/4	4-3/8"	8-3/4"	1-1/4"	29,300	9.75	39320116
1-1/2	5-1/4"	10-1/2"	1-1/2"	39,900	17.12	39320132
1-3/4	6"	12"	1-3/4"	52,100	26.12	39320148

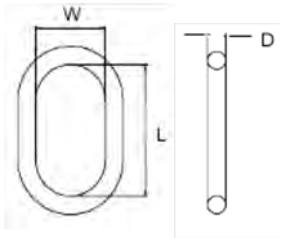

Proof Load : 2 time Working Load limit
 Ultimate Load: 6 times the Working Load Limit

WARNING : NEVER EXCEED WORKING LOAD LIMITS!

Vanguard Steel Ltd. _____



Pear Shaped Snap Hooks

All purpose hook
Cold drawn Mild Steel - Electro Galvanized



Snap Hooks		Dimension Inches					WLL (lbs)	Weight lbs/pc	Product Code
Size	A	B	C	D	E				
1/8"	0.154	0.437	0.230	1.602	0.489	200	0.02	29181008	
3/16"	0.197	0.591	0.315	1.969	0.236	220	0.06	29181012	
1/4"	0.225	0.673	0.365	2.380	0.229	260	0.08	29181016	
5/16"	0.305	0.932	0.497	3.107	0.854	500	0.14	29181020	
3/8"	0.381	1.198	0.625	3.939	0.536	770	0.29	29181024	
1/2"	0.456	1.694	0.699	5.490	1.651	1,400	0.72	29181032	

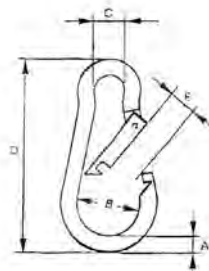

WLL Stamped on each hook
Breaking Strength: 2 times Working Load Limit

WARNING : NEVER EXCEED WORKING LOAD LIMIT (WLL)
DO NOT USE for overhead lifting, to support human weight, for playground or athletic equipment, or as a safety device.
DO NOT USE if visibly distorted or worn.
Misuse can result in serious bodily injury or property damage.



Weldless Pear Links

Alloy Steel
Quenched and Tempered
Hot Dip Galvanized



Pear Links		Dimensions (inches)				WLL (lbs)	Weight lbs/pc	Product Code
Size	A	B	C	D				
3/8"	1.50	0.75	2.25	3/8	1,800	0.23	39321024	
1/2"	2.00	1.00	3.00	1/2	7,000	0.51	39321032	
5/8"	2.50	1.25	3.75	5/8	9,000	1.10	39321040	
3/4"	2.75	1.38	4.50	3/4	12,300	2.00	39321048	
7/8"	3.50	1.75	5.25	7/8	14,000	2.70	39321056	
1"	3.75	1.88	6.00	1	24,360	4.60	39321100	

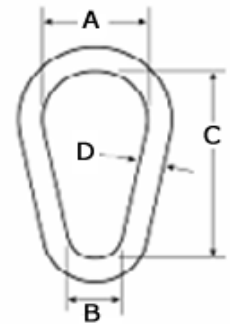

Proof Load : 2 time Working Load limit
Ultimate Load: 6 times the Working Load Limit

WARNING: PROOF LOADING IS MANDATORY FOR THESE PEARLINKS WHEN USED ON ANY OVERHEAD LIFTING APPARATUS! NEVER EXCEED WORKING LOAD LIMITS!



Quick Links

All purpose connector, attaching quickly without tools
Cold drawn Mild Steel - Electro Galvanized



Quick Links		Dimension Inches					WLL (lbs)	Weight lbs/pc	Product Code
Size	A	B	C	D	E				
1/8"	0.210	1.444	0.383	1.171	0.133	220	0.02	29180008	
3/16"	0.256	1.929	0.512	1.535	0.197	660	0.05	29180012	
1/4"	0.295	2.244	0.550	1.772	0.236	880	0.08	29180016	
5/16"	0.426	2.951	0.635	2.353	0.300	1,760	0.18	29180020	
3/8"	0.473	3.228	0.709	2.551	0.354	2,200	0.23	29180024	
7/16"	0.520	3.642	0.787	2.882	0.395	2,600	0.32	29180028	
1/2"	0.571	4.134	0.925	3.189	0.472	3,300	0.52	29180032	

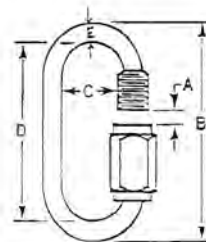

WLL Stamped on each hook

Breaking Strength: 2 times Working Load Limit

Make two into one with this easy connector, requiring no tools

Use with chains of equal or lower working load limit.

WARNING : NEVER EXCEED WORKING LOAD LIMIT (WLL)
DO NOT USE for overhead lifting, to support human weight, for playground or athletic equipment, or as a safety device.
DO NOT USE if visibly distorted or worn.
Misuse can result in serious bodily injury or property damage.

" S " HOOKS

For attaching accessories to chain.
 Low Carbon steel - Electro Galvanized



S Hook	Over all		Weight lbs/pc	Product Code
	A	B		
Size (mm)	Length	Opening		
3 x 25	1"	1/8"	0.02	29300030
4 x 37	1-3/8"	5/32"	0.05	29300040
5 x 45	1-5/8"	3/16"	0.08	29300050
6 x 55	2-1/8"	1/4"	0.18	29300060
8 x 76	3-1/4"	5/16"	0.23	29300080
10 x 103	4"	3/8"	0.32	29300100

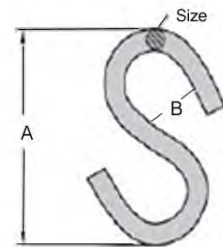

After engaging chain, close the "S' hook to prevent disengagement.

WARNING : NEVER EXCEED WORKING LOAD LIMITS OF CHAIN OR COMPONENTS!
 DO NOT USE for overhead lifting or hoisting
 DO NOT USE if the chain or component are visibly distorted or worn.



Twin Clevis Links

For use with Grade 70 or lower grade chains only

Body: Heat Treated Carbon Steel

Pins: Quenched and Tempered Alloy Steel



Twin Links	Dimensions Inches				Weight lbs/pc	WLL (lbs)	Product Code
	A	R	D	G			
1/4 - 5/16"	0.439	1.236	0.383	0.461	0.31	4,700	39365020
3/8"	0.516	1.379	0.467	0.502	0.54	6,600	39365024
1/2"	0.647	1.724	0.568	0.612	1.18	11,250	39365032

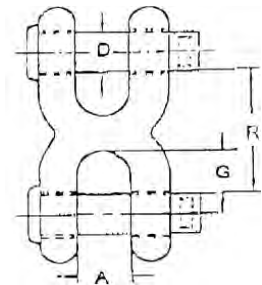

Ultimate load: 4 time Working Load Limit
 Standard Finish Black body, yellow chromated pins

WARNING : NEVER EXCEED WORKING LOAD LIMITS OF CHAIN OR COMPONENTS!
 DO NOT USE for overhead lifting or hoisting
 DO NOT USE if the chain or component are visibly distorted or worn.